

The head-type temporary mesh sock joints are specifically designed to temporarily connect the aluminium, steel or copper conductor to the pulling rope. They consist of variable pitch steel wires, which effectively distribute the gripping effect on the conductor

Certified Quality System  
ISO 9001:2000

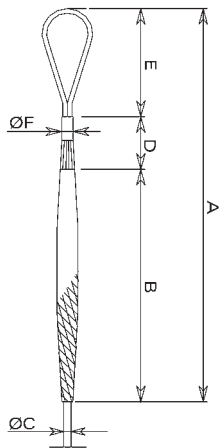

## HEAD-TYPE TEMPORARY MESH SOCK JOINTS

Model	Suitable swivel	Ø C Conductor [mm]	Dimensions [mm]					Identifying colour	Breaking load [kN]	Mass [kg]
			A	B	D	E	F			
GCT 001	GGT 001	8 - 17	1400	1100	140	160	22	yellow	35	0.7
GCT 010	GGT 010	17 - 29	1700	1360	160	180	28	red	85	1.3
GCT 020	GGT 020	29 - 38	1900	1470	200	230	30	green	130	2.1
GCT 030	GGT 020 GGT 030	38 - 50	2270	1820	200	250	34	black	180	2.7

The double head-type temporary mesh sock joints are specifically designed to temporarily connect the aluminium, steel or copper conductors. They consist of variable pitch steel wires, which effectively distribute the gripping effect on the conductor

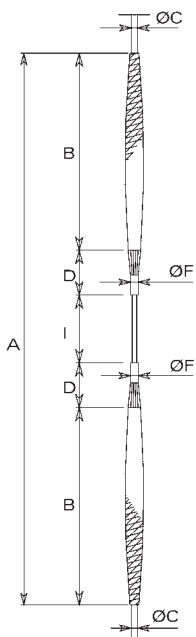

## DOUBLE HEAD-TYPE TEMPORARY MESH SOCK JOINTS

Model	Ø C Conductor [mm]	Dimensions [mm]					Identifying colour	Breaking load [kN]	Mass [kg]
		A	B	D	F	I			
GCT 500	8 - 17	2680	1100	140	22	200	yellow	35	1.15
GCT 510	17 - 29	3240	1360	160	28	200	red	85	2.3
GCT 520	29 - 38	3540	1470	200	30	200	green	130	3.6
GCT 530	38 - 50	4240	1820	200	34	200	black	180	4.8